

Materials included in INVISI-ball Wall Mount

HELMET MOUNT package:

- INVISI-ball HELMET
- Mounting bracket - 1
- Drywall mount – 2
- Screws – 2
- Hex key wrench - 1



US FOOTBALL HELMET | BASEBALL HELMET
HOCKEY GOALIE HELMET | LACROSSE HELMET

MOUNTING INSTRUCTIONS



INSTRUCTIONAL VIDEO: <https://www.youtube.com/watch?v=pJfatZZGfXI&t=28s>

TOOLS NEEDED: Tape measure, Pencil, Power Drill, Screwdriver, 3/16" (5mm) drill bit, Hammer

NOTE: For optimum mounting results, please keep all screws adjusted for proper fit and wing nut tightened "snug". Do not over-tighten wing nut.

MOUNTING INSTRUCTIONS FOR INVISI-ball HELMET Wall Mount

Hanging a helmet on a vertical plane (wall) – see Fig. 2.

*** The **INVISI-ball HELMET Wall Mount** gives the user the option and flexibility to mount Football helmets, Baseball helmets, Hockey helmets / goalie masks and Lacrosse helmets ***

Step 1: Find a desired location where you would want to mount your helmet on the wall.

Step 2: Place the **INVISI-ball HELMET Wall Mount** Mounting Bracket against the wall at the desired position including desired height from floor. Please note that the wall mount component must be facing in the "UP" direction as shown in Figures 1, 3 and 4 on this page. Optionally, a stud sensor may be used to locate a wood stud to reduce the need for a dry wall anchor.

Step 3: Mark with a pencil the desired location for your helmet to be hung. Mark the location where the screw "keyholes" are located.

Step 4: If applying screws directly through the wall and into a stud, drill a small pilot hole to help guide the screw into the wall/stud. If using the drywall anchors - take a 3/16" (5mm) drill bit and drill a hole where the pencil marks have been made in step 3 and add drywall anchors. Taking a hammer and lightly tapping the anchors flush with the wall will provide a proper surface to place the **INVISI-ball HELMET Wall Mount**. This is to be done if a stud is not located where you are locating the holes for the mount.

Step 5: Using a power drill or screwdriver, screw the screws (provided) into the wall or drywall anchors. Be sure to leave enough room to slide the **INVISI-ball HELMET Wall Mount** Mounting Bracket up and down using the keyhole slot.

Step 6: Unscrew wing nut and remove compression plate from HELMET mounting bracket (see Fig. 3)

Step 7: Adjust mounting screws on mounting bracket (See Fig.4) accordingly to fit the profile of the helmet you wish to mount – these mounting screws allow the helmet to match profiles for many of today's sports helmets.

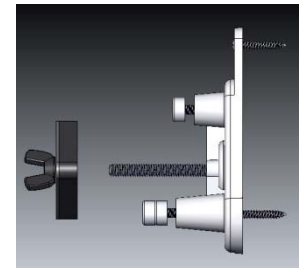

FIG. 1



FIG. 2

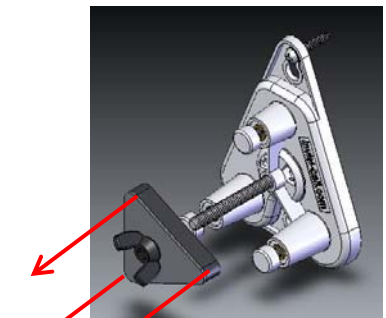

FIG. 3

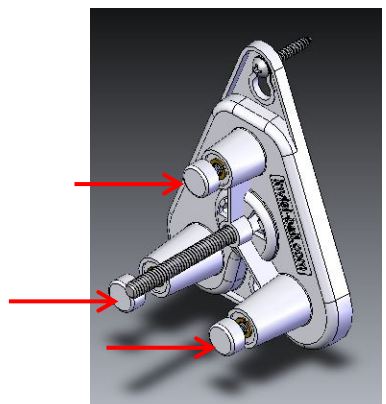
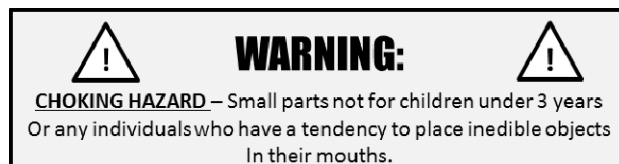

FIG. 4





MOUNTING INSTRUCTIONS



INSTRUCTIONAL VIDEO: <https://www.youtube.com/watch?v=pJfatZZGfXI&t=28s>

MOUNTING INSTRUCTIONS FOR INVISI-ball HELMET Wall Mount -

Continued...

Hanging a helmet on vertical plane (wall)

**** The INVISI-ball HELMET Wall Mount gives the user the options and flexibility to mount Football helmets, Baseball helmets, Hockey helmets / goalie masks and Lacrosse helmets ****

Step 8: Secure the **INVISI-ball HELMET Wall Mount** bracket (Fig. 1) to the wall. Secure the mounting bracket firmly to the wall by tightening the screws provided.

Step 9: Reconfirm step 7 by making final adjustments to the screws on the mounting bracket (Fig. 2) to accommodate the type of helmet that you wish to display on the wall. Remove the vinyl screw caps and use the hex key wrench (provided) if necessary to adjust the mounting screws accordingly. Remember to replace the vinyl screw caps to prevent any potential damage to the helmet you are mounting to the wall.

Step 10: Slide the helmet onto the mount aligning the main stud/screw (Fig. 3) of the mounting bracket and guiding it through an earhole, vent or optimum sized opening on the helmet that will give you the mounting option and look you prefer. Allow the three (vinyl capped) adjustable screws to rest firmly against the outside of the helmet.

Step 11: Use the compression plate and wing nut to secure helmet into place. The compression plate will be placed inside the helmet you are mounting. Rotate compression plate as necessary to prevent the plate from sliding through the ear hole or any other hole in the helmet. Tighten the wing nut snug until the helmet securely mounted to the INVISI-ball HELMET Wall Mount. *Once the wing nut is snug, do not turn the wing nut any more than 2 times after the helmet is secure – this will prevent any potential damage to your helmet or the mount.*

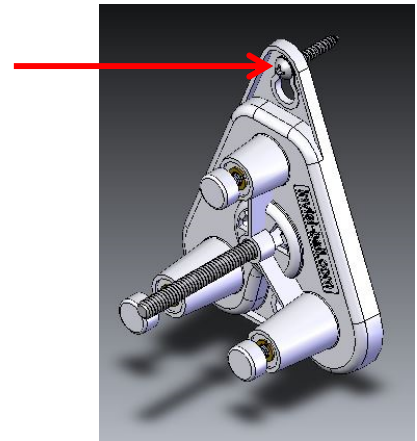

FIG. 1

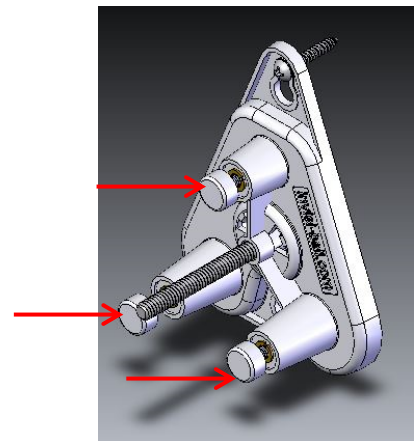

FIG. 2

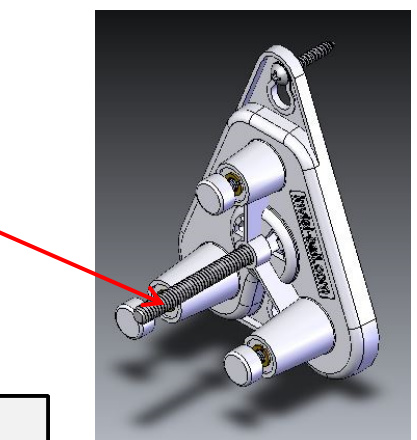
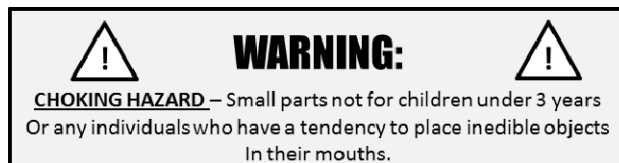
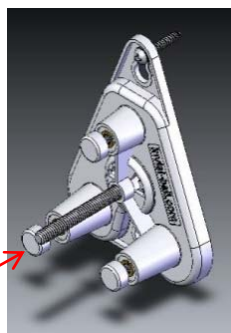
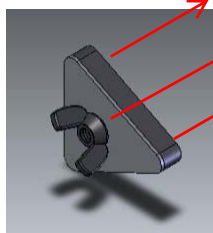

FIG. 3

FIG. 4





MOUNTING INSTRUCTIONS



INSTRUCTIONAL VIDEO: <https://www.youtube.com/watch?v=pJfatZZGfXI&t=28s>

MOUNTING INSTRUCTIONS FOR INVISI-ball HELMET Wall Mount - continued...

Hanging a helmet on a vertical plane (wall) – Helmet types

Illustrated on this page are examples of sports helmets in which the **INVISI-ball HELMET Wall Mount** provides an excellent mounting solution.

Please note that not all types of helmets may not be shown on this page, and that the INVISI-ball Wall Mount can be used with virtually any sports helmet that has existing holes located on the helmet.

Football Helmets: Football helmets are now offered in a wide array of sizes and shapes. Pictured to the right are the most common types of helmets used today. Fig. 1 illustrates a Standard Helmet – note that the ear hole is round. Fig. 2 illustrates a more modern type helmet – revolution type helmet – the ear hole has a more trapezoidal shape. The revolution speed helmets offer the same style ear holes, but with more offsets on the helmets creating a more dynamic and unique look. The **INVISI-ball HELMET Wall Mount** allows for these adjustments in order to conform to all types of football helmets.

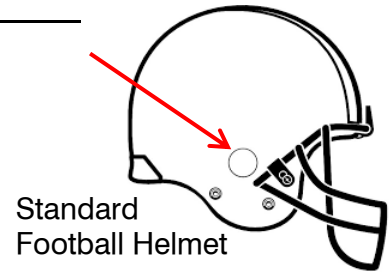

Standard Football Helmet

FIG. 1

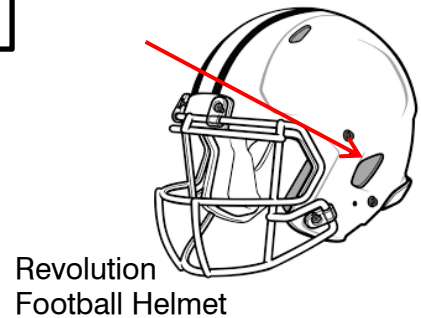

Revolution Football Helmet

FIG. 2

Baseball Helmets: Baseball helmets may have a single opening on either side or multiple openings making it easily accessible for various mounting options offered using the **INVISI-ball HELMET Wall Mount** – see Fig. 3.

Baseball Helmet



FIG. 3

Hockey Helmets / Goalie helmets: Newer models of Hockey helmets and Goalie Masks now offer full face/head protection and also offer multiple openings for mounting options using the **INVISI-ball HELMET Wall Mount**. See Fig 4 – below...

Lacrosse Helmets: Today's Lacrosse helmets also have many openings and vents that allow for a variety mounting options using the **INVISI-ball HELMET Wall Mount**. See Fig. 5 - below...

Lacrosse Helmet

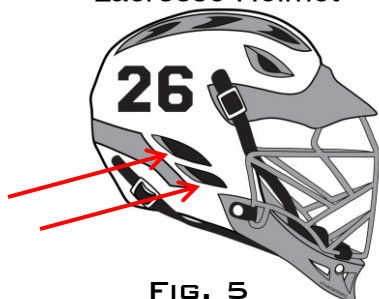

FIG. 5



Goalie Helmet

Hockey Helmet



FIG. 4

INVISI-BALL®

HELMET WALL MOUNT



INSTRUCTIONAL VIDEO: <https://www.youtube.com/watch?v=pJfatZZGfXI&t=28s>

**U.S.
PATENT**
— 9,719,631 —

Universal Helmet Mount Assembly

Also available from INVISI-ball Wall Mount...

BASKETBALL MOUNT



FOOTBALL MOUNT

INVISI-BALL WALL MOUNT®

P.O. Box 2198

APEX, NC 27502

919-817-1487

INVISI-BALL.COM

FOOTBALLONTHEWALL@GMAIL.COM



**INVISI-ball Wall Mount products are manufactured,
assembled and distributed in the U.S.A.**



WARNING:



CHOKING HAZARD – Small parts not for children under 3 years
Or any individuals who have a tendency to place inedible objects
in their mouths.